

3/8" – 4"

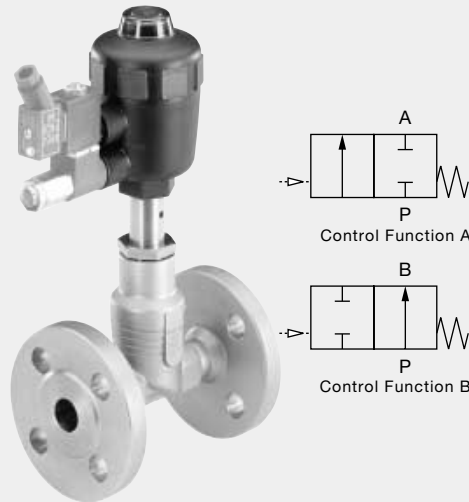

Picture showing a complete Burkert System using Type 2012 with 6012 Banjo

**Advantages/Benefits**

- ▶ Safe, rugged design
- ▶ Maintenance-free
- ▶ Easy to install
- ▶ Extra high life cycle
- ▶ Modular accessories
- ▶ Compact, lightweight
- ▶ "Drop In" ANSI face to face dimensions

**Applications**

**Pharmaceutical**

- Sterilizers; Steam
- Oxygen Control

**Food & Beverage**

- CIP / SIP; Steam
- Auxiliary Processes

**Water Treatment**

- Air Control, Oxygen Control
- Chemical Dosing

**Cosmetics**

- CIP / SIP; Steam

**Textile**

- Steam; Water; Air; Dyeing

The externally piloted globe valve consists of a pneumatically operated piston actuator and a 2/2-way valve body.

The actuator is made of polyamide (PA) or for higher temperatures poly phenyl sulfide (PPS). The proven self-adjusting packing gland assures leak-tightness. The valve body, with its favorable flow characteristics, enables high flow rates.

**Technical Data**

**Materials**

Body Cast Stainless Steel 316 L

(conform to 1.4409)

Actuator PA or PPS

Sealing PTFE (NBR, FPM and EPDM on request)

Process media (for gases and liquids) • For neutral gases, water, alcohols, oils, fuels, hydraulic liquids, salt solutions, lyes, organic solvents, steam (150 PSI 356°F)

- Below seat only gases & steam
- Available "cleaned for oxygen service"

Viscosity Max. 600 mm<sup>2</sup>/s

Packing gland PTFE V-rings (silicone grease) with spring compensation

Installation As required, but preferably with Actuator upright

Nominal pressure 360 PSI (PN 25 body)

Temperatures Fluid -14°F – 356°F (PTFE seal<sup>1</sup>)

Ambient (depending on actuator) -14°F – 140°F<sup>1</sup> (PA)

41°F – 284°F (PPS <100)

41°F – 194°F (PPS ≥100) (short +284°F)

Control media Neutral gases, air

Max. pilot pressure ≤ Actuator size 80 150 PSI (PA and PPS)

Actuator size 100 150 PSI (PA)

Actuator size 100 100 PSI (PPS)

Actuator size 125 100 PSI (PA and PPS)

**Port connections**

Flange ANSI • ANSI B16.5 RF<sup>4</sup>) Class 150  
• Face-to-Face ISA S75.03 (ANSI B16.10)

DIN • DIN 2634 RF<sup>4</sup>)  
• Face-to-Face EN 558-1 (DIN 3202)

JIS • JIS B2238 ordinary type  
JIS 10K RF<sup>4</sup>)  
• Face-to-Face JIS B2002 series 20, ANSI B16.10 (EN 558-2)

| Size<br>[in] | Actuator size<br>[mm] | C <sub>v</sub> | Min. pilot pressure <sup>2)</sup><br>[PSI] | Max. operating pressure <sup>3)</sup> ≤ 356°F |               | Weight<br>[lb] |
|--------------|-----------------------|----------------|--|---|---------------|----------------|
|              |                       |                |  | CF A<br>[PSI]                                 | CF B<br>[PSI] |                |
| 3/8          | C-40                  | 3.53           | 58.00                                      | 217.50  | 232.00        | 5.06           |
| 3/8          | D-50                  | 3.53           | 58.55                                      | 232.00  | 232.00        | 5.28           |
| 1/2          | C-40                  | 5.53           | 58.00                                      | 217.50  | 232.00        | 5.06           |
| 1/2          | D-50                  | 5.53           | 58.55                                      | 232.00  | 232.00        | 5.28           |
| 3/4          | C-40                  | 9.53           | 58.00                                      | 94.25   | 232.00        | 6.82           |
| 3/4          | D-50                  | 9.53           | 58.55                                      | 159.50  | 232.00        | 7.26           |
| 3/4          | E-63                  | 9.53           | 60.90                                      | 232.00  | –             | 8.14           |
| 1            | D-50                  | 14.11          | 58.55                                      | 232.00  | –             | 9.24           |
| 1            | E-63                  | 15.29          | 60.90                                      | 159.50  | 232.00        | 10.12          |
| 1            | F-80                  | 15.29          | 72.50                                      | 232.00  | –             | 11.88          |
| 1-1/4        | E-63                  | 22.93          | 60.90                                      | 101.50  | 232.00        | 14.52          |
| 1-1/4        | F-80                  | 22.93          | 72.50                                      | 232.00  | –             | 16.28          |
| 1-1/2        | E-63                  | 36.46          | 60.90                                      | 232.00  | –             | 16.72          |
| 1-1/2        | F-80                  | 36.46          | 72.50                                      | 145.00  | 232.00        | 18.48          |
| 1-1/2        | H-125                 | 36.46          | 46.40                                      | 232.00  | –             | 30.58          |
| 2            | E-63                  | 52.92          | 60.90                                      | 232.00  | –             | 20.46          |
| 2            | F-80                  | 52.92          | 72.50                                      | 232.00  | –             | 22.22          |
| 2            | G-100                 | 52.92          | 63.80                                      | 130.50  | 232.00        | 29.7           |
| 2            | H-125                 | 52.92          | 46.40                                      | 159.50  | –             | 34.32          |

1) In combination with max. ambient temperature of 131°F, the max. fluid temperature is 230°F for PA actuators sizes 40, 50 and 63.

2) Circuit function B below seat and circuit function A above seat, please see charts on page 2.

3) Steam up to 356°F / 150 PSI.

4) Raised face (RF)

# 2/2-Way Globe Valve, Pneumatically Operated

## Cast Stainless Steel Body with Flanges

# Type 2012

## ON/OFF Globe Valve

### Dimensions [mm]

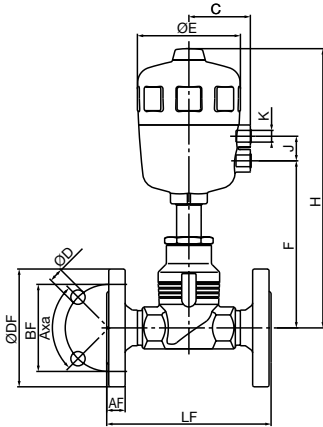

| All Actuators |                  |    |     |     |     |       |      |         | DIN Flange |     |     |    |    | ANSI 150 Flange RF |     |       |      |      | JIS Flange |     |     |    |    |    |
|---------------|------------------|----|-----|-----|-----|-------|------|---------|------------|-----|-----|----|----|--------------------|-----|-------|------|------|------------|-----|-----|----|----|----|
| Size (in)     | Act. size $\phi$ | C  | E   | F   | H   | K     | J    | A x a   | DF         | LF  | BF  | AF | D  | DF                 | LF  | BF    | AF   | D    | DF         | LF  | BF  | AF | D  |    |
| 3/8           | C-40             | 33 | 53  | 116 | 168 | G 1/8 | 16.5 |         | 90         | 130 | 60  | 16 | 14 | -                  | -   | -     | -    | -    | -          | -   | -   | -  | -  | -  |
| 3/8           | D-50             | 44 | 64  | 131 | 211 | G 1/4 | 24.0 |         | 90         | 130 | 60  | 16 | 14 | -                  | -   | -     | -    | -    | -          | -   | -   | -  | -  | -  |
| 1/2           | C-40             | 33 | 53  | 116 | 168 | G 1/8 | 16.5 |         | 95         | 130 | 65  | 16 | 14 | 89.0               | 184 | 60.5  | 11.2 | 15.7 | 95         | 108 | 70  | 12 | 15 | 15 |
| 1/2           | D-50             | 44 | 64  | 131 | 211 | G 1/4 | 24.0 |         | 95         | 130 | 65  | 16 | 14 | 89.0               | 184 | 60.5  | 11.2 | 15.7 | 95         | 108 | 70  | 12 | 15 | 15 |
| 3/4           | C-40             | 33 | 53  | 118 | 170 | G 1/8 | 16.5 |         | 105        | 150 | 75  | 18 | 14 | 99.0               | 184 | 69.9  | 12.7 | 15.7 | 100        | 117 | 75  | 14 | 15 | 15 |
| 3/4           | D-50             | 44 | 64  | 135 | 213 | G 1/4 | 24.0 |         | 105        | 150 | 75  | 18 | 14 | 99.0               | 184 | 69.9  | 12.7 | 15.7 | 100        | 117 | 75  | 14 | 15 | 15 |
| 3/4           | E-63             | 52 | 80  | 155 | 247 | G 1/4 | 24.0 |         | 105        | 150 | 75  | 18 | 14 | 99.0               | 184 | 69.9  | 12.7 | 15.7 | 100        | 117 | 75  | 14 | 15 | 15 |
| 1             | D-50             | 44 | 64  | 140 | 220 | G 1/4 | 24.0 |         | 115        | 160 | 85  | 18 | 14 | 108.0              | 184 | 79.2  | 14.2 | 15.7 | 125        | 127 | 90  | 14 | 19 | 19 |
| 1             | E-63             | 52 | 80  | 159 | 251 | G 1/4 | 24.0 | 4 x 90° | 115        | 160 | 85  | 18 | 14 | 108.0              | 184 | 79.2  | 14.2 | 15.7 | 125        | 127 | 90  | 14 | 19 | 19 |
| 1             | F-80             | 60 | 101 | 164 | 273 | G 1/4 | 24.0 |         | 115        | 160 | 85  | 18 | 14 | 108.0              | 184 | 79.2  | 14.2 | 15.7 | 125        | 127 | 90  | 14 | 19 | 19 |
| 1-1/4         | E-63             | 52 | 80  | 179 | 271 | G 1/4 | 24.0 |         | 140        | 180 | 100 | 18 | 18 | -                  | -   | -     | -    | -    | 135        | 140 | 100 | 16 | 19 | 19 |
| 1-1/4         | F-80             | 60 | 101 | 184 | 294 | G 1/4 | 24.0 |         | 140        | 180 | 100 | 18 | 18 | -                  | -   | -     | -    | -    | 135        | 140 | 100 | 16 | 19 | 19 |
| 1-1/2         | E-63             | 52 | 80  | 184 | 276 | G 1/4 | 24.0 |         | 150        | 200 | 110 | 18 | 18 | 127.0              | 222 | 98.6  | 17.5 | 15.7 | 140        | 165 | 105 | 16 | 19 | 19 |
| 1-1/2         | F-80             | 60 | 101 | 189 | 299 | G 1/4 | 24.0 |         | 150        | 200 | 110 | 18 | 18 | 127.0              | 222 | 98.6  | 17.5 | 15.7 | 140        | 165 | 105 | 16 | 19 | 19 |
| 1-1/2         | H-125            | 86 | 153 | 220 | 397 | G 1/4 | 30.0 |         | 150        | 200 | 110 | 18 | 18 | 127.0              | 222 | 98.6  | 17.5 | 15.7 | 140        | 165 | 105 | 16 | 19 | 19 |
| 2             | E-63             | 52 | 80  | 195 | 287 | G 1/4 | 24.0 |         | 165        | 230 | 125 | 20 | 18 | 152.4              | 254 | 120.7 | 19.1 | 19.1 | 155        | 203 | 120 | 16 | 19 | 19 |
| 2             | F-80             | 60 | 101 | 199 | 309 | G 1/4 | 24.0 |         | 165        | 230 | 125 | 20 | 18 | 152.4              | 254 | 120.7 | 19.1 | 19.1 | 155        | 203 | 120 | 16 | 19 | 19 |
| 2             | G-100            | 73 | 127 | 218 | 370 | G 1/4 | 30.0 |         | 165        | 230 | 125 | 20 | 18 | 152.4              | 254 | 120.7 | 19.1 | 19.1 | 155        | 203 | 120 | 16 | 19 | 19 |
| 2             | H-125            | 86 | 153 | 225 | 402 | G 1/4 | 30.0 |         | 165        | 230 | 125 | 20 | 18 | 152.4              | 254 | 120.7 | 19.1 | 19.1 | 155        | 203 | 120 | 16 | 19 | 19 |

### Pressure rating normally open below seat

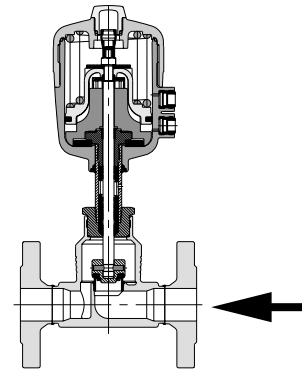
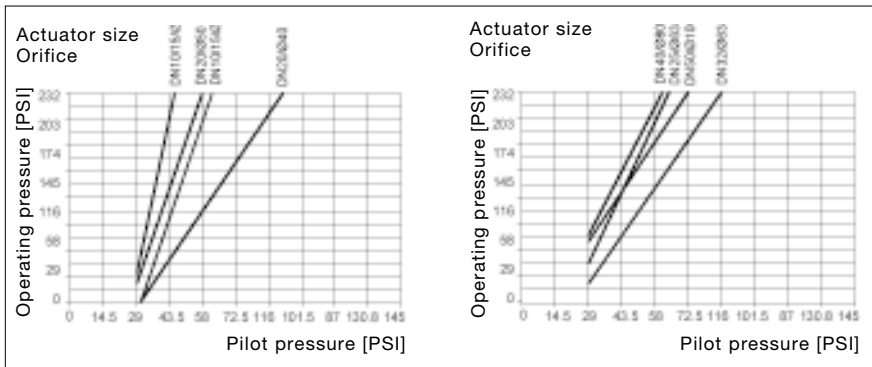

### Pressure rating normally closed above seat

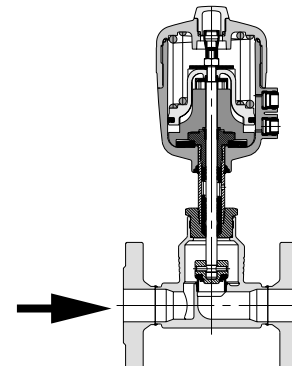
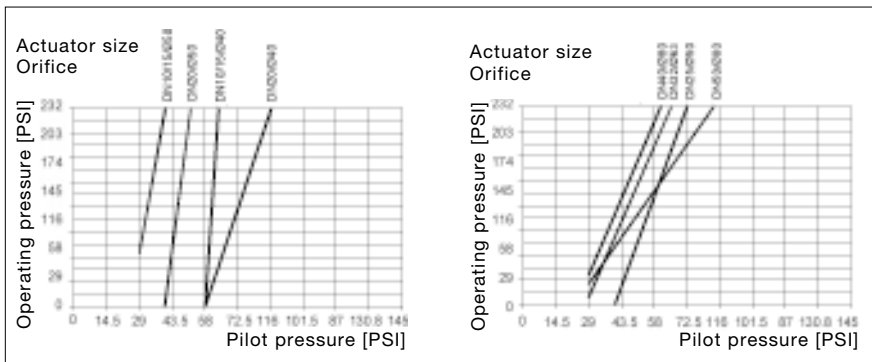

# 2/2-Way Globe Valve, Pneumatically Operated

## Cast Stainless Steel Body with Flanges

# Type 2012

## ON/OFF Globe Valve

### Ordering chart

| Flange  |              |                      | Flow below seat |              | Flow above seat |              |            |
|---|--------------|----------------------|-----------------|--------------|-----------------|--------------|------------|
| <ul style="list-style-type: none"> <li>ANSI B16.5 Class 150</li> <li>Face-to-Face (EN 558-2 or ANSI 16.10)</li> <li>ISA S75.03</li> </ul> |              |                      | Item-No.        | Item-No.     | Item-No.        | Item-No.     |            |
| Circuit Function  | Size DN [in] | Actuator size ø [mm] | PA-Actuator     | PPS-Actuator | PA-Actuator     | PPS-Actuator |            |
| A<br>Normally Closed  | 15           | 1/2                  | C-40            | 146 246 A    | -               | 146 436 R    | -          |
|   | 15           | 1/2                  | D-50            | 146 258 N    | on request      | 146 442 X    | on request |
|   | 20           | 3/4                  | C-40            | 146 270 N    | -               | 146 447 U    | -          |
|   | 20           | 3/4                  | D-50            | 146 282 X    | -               | 146 453 S    | on request |
|   | 20           | 3/4                  | E-63            | 146 294 T    | on request      | -            | -          |
|   | 25           | 1                    | D-50            | -            | -               | 146 459 G    | on request |
|   | 25           | 1                    | E-63            | 146 571 Y    | -               | -            | -          |
|   | 25           | 1                    | F-80            | 146 572 Z    | on request      | -            | -          |
|   | 40           | 1-1/2                | E-63            | -            | -               | 146 469 A    | -          |
|   | 40           | 1-1/2                | F-80            | 146 326 S    | -               | 146 475 Y    | on request |
|   | 40           | 1-1/2                | H-125           | 146 338 E    | on request      | -            | -          |
|   | 50           | 2                    | E-63            | -            | -               | 146 480 S    | -          |
|   | 50           | 2                    | F-80            | -            | -               | 146 486 L    | on request |
|   | 50           | 2                    | G-100           | 146 344 C    | -               | -            | -          |
|   | 50           | 2                    | H-125           | 146 356 G    | on request      | -            | -          |
|   |              | 75                   | 3               | on request   |                 |              |            |
|   |              | 100                  | 4               | on request   |                 |              |            |
| B<br>Normally Open  | 15           | 1/2                  | C-40            | 146 252 G    | -               |              |            |
|   | 15           | 1/2                  | D-50            | 146 264 C    | on request      |              |            |
|   | 20           | 3/4                  | C-40            | 146 276 G    | -               |              |            |
|   | 20           | 3/4                  | D-50            | 146 388 D    | on request      |              |            |
|   | 25           | 1                    | E-63            | 146 304 D    | on request      |              |            |
|   | 40           | 1-1/2                | F-80            | 146 332 Y    | on request      |              |            |
|   | 50           | 2                    | G-100           | 146 350 N    | on request      |              |            |
|   | 75           | 3                    | on request      |              |                 |              |            |
| 100   | 4            | on request           |                 |              |                 |              |            |

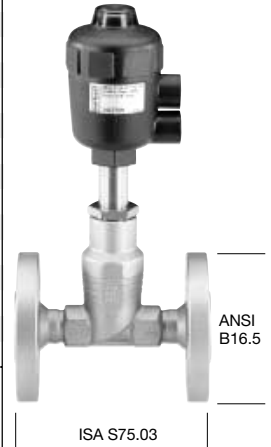

| Flange  |             |                      | Flow below seat |              | Flow above seat |              |
|---|-------------|----------------------|-----------------|--------------|-----------------|--------------|
| <ul style="list-style-type: none"> <li>DIN 2634</li> <li>Face-to-Face EN 558-1</li> <li>(DIN 3202)</li> </ul> |             |                      | Item-No.        | Item-No.     | Item-No.        | Item-No.     |
| Circuit Function  | Size [inch] | Actuator size ø [mm] | PA-Actuator     | PPS-Actuator | PA-Actuator     | PPS-Actuator |
| A<br>Normally Closed  | 3/8         | C-40                 | 146 227 X       | 146 362 E    | 146 427 Q       | -            |
|   | 3/8         | D-50                 | 146 237 Z       | 146 370 J    | 146 432 M       | 146 492 J    |
|   | 1/2         | C-40                 | 146 247 B       | -            | 146 437 J       | -            |
|   | 1/2         | D-50                 | 146 259 P       | 146 378 N    | 146 443 Y       | 146 496 N    |
|   | 3/4         | C-40                 | 146 271 B       | -            | 146 448 D       | -            |
|   | 3/4         | D-50                 | 146 283 Y       | -            | 146 454 T       | 146 500 E    |
|   | 3/4         | E-63                 | 146 295 U       | 146 390 F    | -               | -            |
|   | 1           | D-50                 | -               | -            | 146 460 D       | 146 504 W    |
|   | 1           | E-63                 | 146 299 G       | -            | -               | -            |
|   | 1           | F-80                 | 146 310 E       | 146 398 B    | -               | -            |
|   | 1-1/4       | E-63                 | 145 314 W       | -            | 146 465 W       | 146 508 A    |
|   | 1-1/4       | F-80                 | 146 322 W       | 146 406 U    | -               | -            |
|   | 1-1/2       | E-63                 | -               | -            | 146 470 F       | -            |
|   | 1-1/2       | F-80                 | 146 327 T       | -            | 146 476 Z       | 146 512 M    |
|   | 1-1/2       | H-125                | 146 339 F       | 146 414 K    | -               | -            |
|   | 2           | E-63                 | -               | -            | 146 481 P       | -            |
|   | 2           | F-80                 | -               | -            | 146 487 M       | 146 516 R    |
|   | 2           | G-100                | 146 345 D       | -            | -               | -            |
|   | 2           | H-125                | 146 357 H       | 146 422 K    | -               | -            |
| B<br>Normally Open  | 3/8         | C-40                 | 146 232 U       | 146 366 A    |                 |              |
|   | 3/8         | D-50                 | 146 242 E       | 146 374 A    |                 |              |
|   | 1/2         | C-40                 | 146 253 H       | -            |                 |              |
|   | 1/2         | D-50                 | 146 265 D       | 146 382 T    |                 |              |
|   | 3/4         | C-40                 | 146 277 H       | -            |                 |              |
|   | 3/4         | D-50                 | 146 289 E       | 146 386 X    |                 |              |
|   | 1           | E-63                 | 146 305 E       | 146 394 X    |                 |              |
|   | 1-1/4       | E-63                 | 146 318 A       | 146 402 Y    |                 |              |
|   | 1-1/2       | F-80                 | 146 333 Z       | 146 410 T    |                 |              |
|   | 2           | G-100                | 146 351 B       | 146 418 X    |                 |              |



# 2/2-Way Globe Valve, Pneumatically Operated

## Cast Stainless Steel Body with Flanges

# Type 2012

## ON/OFF Globe Valve

| Flange  |      |       | Flow below seat           |             | Flow above seat |             |              |
|---|------|-------|---------------------------|-------------|-----------------|-------------|--------------|
| <ul style="list-style-type: none"> <li>JIS B2238 ord. type; JIS 10K</li> <li>Face-to-Face JIS B2002 S20 (ANSI B16.10) (EN 558-2)</li> </ul> |      |       |                           |             |                 |             |              |
| Circuit Function  | Size |       | Actuator size $\phi$ [mm] | Item-No.    | Item-No.        | Item-No.    | Item-No.     |
|   | DN   | [in]  |                           | PA-Actuator | PPS-Actuator    | PA-Actuator | PPS-Actuator |
| A   | 15   | 1/2   | C-40                      | 146 377 P   | -               | 146 486 U   | -            |
|   | 15   | 1/2   | D-50                      | 146 379 Z   | on request      | 146 397 C   | on request   |
|   | 20   | 3/4   | C-40                      | 146 382 D   | -               | 146 398 M   | -            |
|   | 20   | 3/4   | D-50                      | 146 384 F   | -               | 146 399 N   | on request   |
|   | 20   | 3/4   | E-63                      | 146 387 A   | on request      | -           | -            |
|   | 25   | 1     | D-50                      | -           | -               | 146 400 L   | on request   |
|   | 25   | 1     | E-63                      | 146 388 K   | -               | -           | -            |
|   | 25   | 1     | F-80                      | 146 390 R   | on request      | -           | -            |
|   | 40   | 1-1/2 | E-63                      | -           | -               | 146 401 H   | -            |
|   | 40   | 1-1/2 | F-80                      | 146 391 E   | -               | 146 402 A   | on request   |
|   | 40   | 1-1/2 | H-125                     | 146 393 G   | on request      | -           | -            |
|   | 50   | 2     | E-63                      | -           | -               | 146 481 P   | -            |
|   | 50   | 2     | F-80                      | -           | -               | 146 404 C   | on request   |
|   | 50   | 2     | G-100                     | 146 394 H   | -               | -           | -            |
|   | 50   | 2     | H-125                     | 146 396 B   | on request      | -           | -            |
| B   | 15   | 1/2   | C-40                      | 146 378 Y   | -               | -           | -            |
|   | 15   | 1/2   | D-50                      | 146 381 C   | on request      | -           | -            |
|   | 20   | 3/4   | C-40                      | 146 383 E   | -               | -           | -            |
|   | 20   | 3/4   | D-50                      | 146 386 H   | on request      | -           | -            |
|   | 25   | 1     | E-63                      | 146 389 L   | on request      | -           | -            |
|   | 40   | 1-1/2 | F-80                      | 146 392 F   | on request      | -           | -            |
|   | 50   | 2     | G-100                     | 146 395 A   | on request      | -           | -            |



### Further Process Connections are:

Threaded Ends

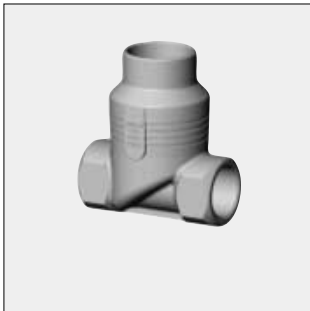

Weld Ends

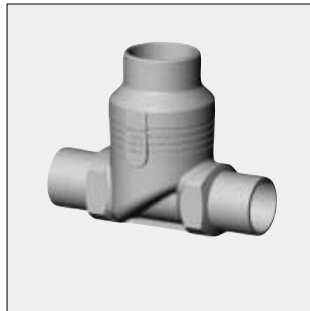

Tri-Clamp®



Customized\*

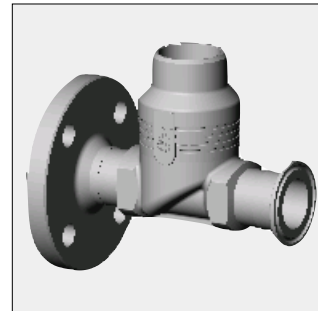

\* e.g. one side with flange, other side Tri-Clamp®

# 2/2-Way Globe Valve, Pneumatically Operated Cast Stainless Steel Body with Flanges

**Type 2012**  
ON/OFF Globe Valve

## Valve Actuation System: Banjo Valve

Type 6012, 6014

Banjo Valves are pneumatic single pilot valves designed for easy mounting onto pneumatic actuators. Simply screwed into the pressure port of the actuator the banjo valve may be rotated into any position. In addition the banjo valve Types 6012 and 6014, based on a modular concept, have a push-over coil, which can be locked in any position. Also available with cable plug for AS-i fieldbus connectivity.

➔ see Datasheet Type 6012, 6014 Banjo



## Valve Actuation System: NAMUR Valve

Type 5470, 6519

Burkert NAMUR valves are extremely reliably switching, diaphragm-driven, seat valves. The valve, which is manufactured from high quality plastic, can be operated in its 5/2 or 3/2 way function. The 3/2 way function works with exhaust feedback into the spring space. In this way, the penetration of aggressive external air into the interior of the drive is prevented. Also available with cable plug for AS-i fieldbus connectivity.

➔ see Datasheet Type 5470, 6519 NAMUR



## Valve Actuation System: Mini TOP

Type 8633

The Mini TOP combines pilot valves and position feedback in a fully integrated, extremely compact design. Due to its modular design, the Mini TOP can be easily plugged onto a globe valve. Both single and double acting actuators are possible. Position feedback can be delivered by using mechanical or inductive limit switches. The unique design reduces installation and commissioning costs to a minimum. It offers standard connections to valve actuators, intelligent sensors and process network interfaces like AS-i. For actuator size C, D, E, and F.

➔ see Datasheet Type 8633



## Valve Actuation System: TOP Control ON/OFF

Type 8631

The TOP Control ON/OFF combines pilot valves and position feedback in one device. TOP Control ON/OFF and pneumatic actuator are mechanically connected and form a mechanical and functional unit. The modular construction enables one to realize units of different complexity and different electrical connection concepts. Both single and double acting actuators are possible, adjustable position feedback can be obtained using mechanical or inductive sensors. On failure of the supply voltage or the pneumatic energy, the valve will move to a safety position. For actuator size C, D, E, F, G, and H.



## Valve Actuation System: AirLINE

Type 8644

The AirLINE System integrates solenoid pilot valves, remote electrical I/Os with WAGO, PHOENIX, Beckhoff or Siemens and Fieldbus communication to a very compact and flexible Process Actuation Control System. Its modular design allows fully customized, pre-wired and tested solutions to exactly meet any application needs.

➔ see Datasheet Type 8644

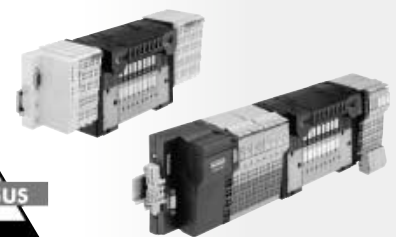

### Further Modular Options (→ see datasheet Type 2000 - 2031 accessories)

#### Position Feedback

##### 1060

- For alarm & emergency devices, safety disconnectors & sequence arrangements
- Additional optical position indication
- Simple installation
- Retrofittable
- Easily accessible elements & terminals
- Compact NEMA 4 (IP65) enclosure

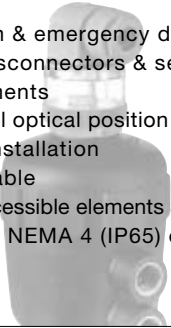

#### Manual Override

- Normally closed manual override (control function "closed when depressurized" only)
- Integrated optical position indication
- Retrofittable
- Can be combined with external inductive position indication Type 1071

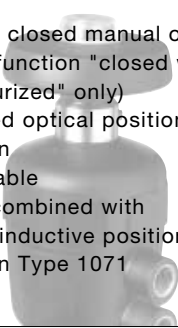

#### Stroke Limitation

- Max./min. flow setting
- Integr., clear optical position indication
- Retrofittable
- Upper and lower stop adjustable with standard screw driver
- Can be combined with external inductive position indication Type 1071

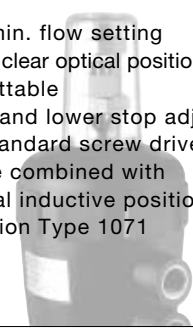

##### 1062

- Mechanical, inductive 3-wire and EExi technology
- Simple installation
- Retrofittable
- Can be rotated by 360°
- LEDs provide local operational status and position indication
- Compact NEMA 4 (IP65) enclosure

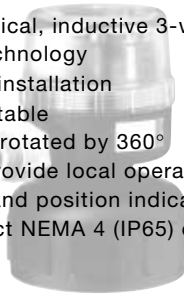

- Stroke limitation single version\*
- Easy adjustment with Allen key
- Can be combined with external inductive position indication Type 1071

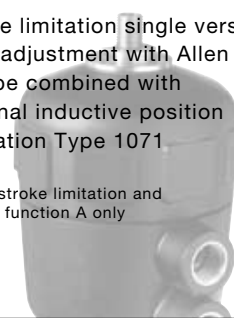

\* Upper stroke limitation and control function A only

##### 1071

- For combinations with stroke adjustment & manual override
- Reliable switching function
- Space saving design, simple installation
- LED display
- Reverse polarity protection
- Short circuit proof
- Pulsed PNP
- Protected against inductive spikes
- A magnetic piston is required



#### Burkert Contromatic USA

2602 McGaw Avenue  
Irvine, CA 92614  
Tel. 949.223.3100  
Fax 949.223.3198  
www.burkert-usa.com

#### Burkert Contromatic Inc.

760 Pacific Road, Unit 3  
Oakville, Ontario, Canada L6L 6M5  
Tel. 905.847.5566  
Fax 905.847.9006  
www.burkert.ca

### Globe Valve Systems

A globe valve system consists of a globe valve and a valve actuation. Burkert offers a wide range of valve actuation systems suitable for the new globe valve, including banjo valves type 6012/6014, NAMUR valves type 5470/6519, Mini TOP 8633, TOP Control 8633 and AirLINE 8644.

#### Example for Variations of globe valve ON/OFF Systems

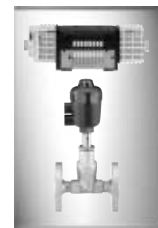

Globe Valve



Valve Actuation



Complete Globe Valve Systems

2012  
Globe Valve  
with required  
process  
connection

Valve Actuation  
with all its  
needs

2012 + 6012  
Globe Valve  
banjo system

2012 + 6519  
Globe Valve  
NAMUR  
system

2012 + 8633  
Globe Valve  
Mini TOP  
system

2012 + 8631  
Globe Valve  
TOP Control  
system

2012 + 8644  
Globe Valve  
AirLINE  
system

In case of special requirements  
please consult for advice.

We reserve the right to make technical  
changes without notice.

US\_2012FL\_07/01